

# ILEC

ILEC CONFERENCE CENTRE  
IBIS LONDON EARLS COURT

Booking enquiries

Tel: +44 (0)207 666 8470  
Fax: +44 (0)207 666 8588  
Email: [h5623-sb@accor.com](mailto:h5623-sb@accor.com)

ILEC Conference Centre  
47 Lillie Road  
London  
SW6 1UD

# ILEC

ILEC CONFERENCE CENTRE  
IBIS LONDON EARLS COURT



[www.ileconferencecentre.com](http://www.ileconferencecentre.com)

London's largest three star conference hotel

A unique  
event space  
in West London

1700<sup>m<sup>2</sup></sup>

With over 1700sqm of event space, ILEC Conference Centre boasts one of the largest conference spaces in London.

Best known for its sheer size, flexibility of space and latest technological features, the newly renovated London Suite is a stunning ballroom for events of any size and type. With 5 additional small to medium boardrooms, ILEC Conference centre can cater for events from 2 to 1200 guests.

A conference  
hall designed  
to fit your  
needs

The new London Suite has been cleverly designed to fit the changing needs of event planners.

The open-floor parts into 9 conference modules of various sizes: divide, combine and play them endlessly to create a space that fits your event to perfection.

Because a conference for 20 or 1200 needs the same high standard of quality, the suite has been fitted with the latest audio, lighting and other hi-tech solutions.



Exhibit in our  
large wide-  
open and  
high  
ceiling  
space

The 1260sqm, 5 metre high and pillar-free London suite is suitable for exhibitions of any type. The Suite is also fitted with a 5 metre wide loading bay door at street level to bring goods of all size into the room.

Additionally the hall can shift to create forum space or VIP areas right within the exhibition floor.

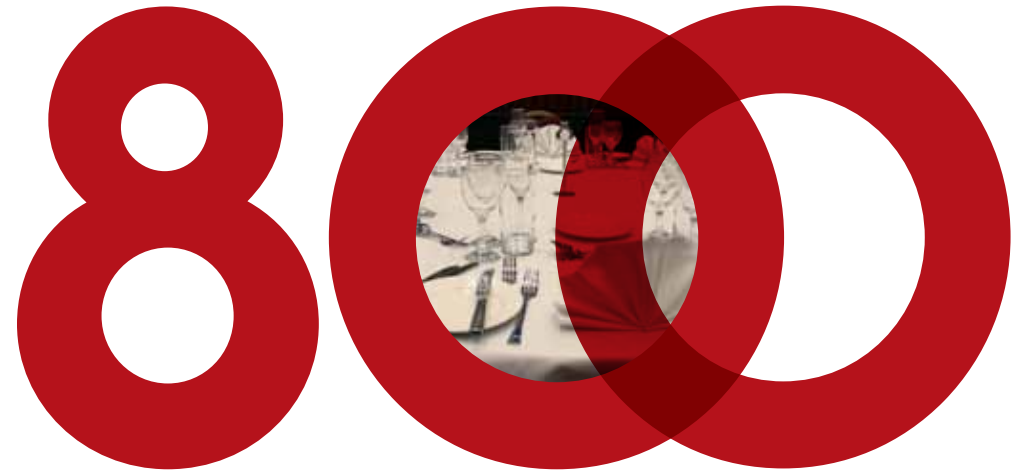

An evening to  
remember



Fully open, the London Suite will transform into an astonishing ballroom to set your gala dinners, wedding receptions, award ceremonies, Christmas parties and more, accommodating up to 800 guests.

Our in-house event production company can help you design a night to remember whilst our chef can prepare outstanding menus to please any taste and budget.



# Specifications

| Capacity             | London |       | Dimensions                | Foyer  |       |
|----------------------|--------|-------|---------------------------|--------|-------|
|                      | London | Foyer |                           | London | Foyer |
| Theatre              | 1200   | -     | Length (m)                | 39     | 35    |
| Classroom            | 750    | -     | Width (m)                 | 31     | 7     |
| Cabaret              | 600    | -     | Height (m)                | 5      | 2.4   |
| Round - Dinner       | 800    | -     | Surface (m <sup>2</sup> ) | 1260   | 291   |
| Round - Dinner Dance | 800    | -     |                           |        |       |
| Reception            | 1200   | 250   |                           |        |       |



| Capacity             | London |    |     |    |    |    |     |      |     |  |
|----------------------|--------|----|-----|----|----|----|-----|------|-----|--|
|                      | I      | II | III | IV | V  | VI | VII | VIII | IX  |  |
| Theatre              | 40     | 35 | 35  | 35 | 35 | 40 | 200 | 160  | 200 |  |
| Classroom            | 20     | 16 | 16  | 16 | 16 | 20 | 80  | 40   | 80  |  |
| Cabaret              | 30     | 26 | 26  | 26 | 26 | 30 | 60  | 50   | 60  |  |
| Round - Dinner       | 30     | 30 | 30  | 30 | 30 | 30 | 140 | 120  | 140 |  |
| Round - Dinner Dance | -      | -  | -   | -  | -  | -  | 100 | 80   | 100 |  |
| Reception            | 50     | 50 | 50  | 50 | 50 | 50 | 200 | 160  | 200 |  |
| Boardroom            | 30     | 26 | 26  | 26 | 26 | 30 | -   | -    | -   |  |
| U-shape              | 20     | 25 | 18  | 18 | 25 | 20 | -   | -    | -   |  |

| Dimensions                | London |      |      |      |      |      |     |      |     |  |
|---------------------------|--------|------|------|------|------|------|-----|------|-----|--|
|                           | I      | II   | III  | IV   | V    | VI   | VII | VIII | IX  |  |
| Length (m)                | 6      | 5.5  | 5.6  | 5.6  | 5.5  | 6.5  | 14  | 11   | 14  |  |
| Width (m)                 | 10.5   | 10.5 | 10.5 | 10.5 | 10.5 | 10.5 | 14  | 14   | 14  |  |
| Height (m)                | 5      | 5    | 5    | 5    | 5    | 5    | 5   | 5    | 5   |  |
| Surface (m <sup>2</sup> ) | 63     | 58   | 58   | 58   | 58   | 68   | 190 | 154  | 193 |  |

| Capacity             | I, II & III<br>or IV, V & VI | VII & VIII | VII, VIII & IX |
|----------------------|------------------------------|------------|----------------|
| Theatre              | 110                          | 360        | 560            |
| Classroom            | 52                           | 120        | 200            |
| Cabaret              | 82                           | 110        | 170            |
| Round - Dinner       | 90                           | 260        | 400            |
| Round - Dinner Dance | -                            | 180        | 280            |
| Reception            | 150                          | 360        | 560            |
| Boardroom            | 82                           | -          | -              |
| U-shape              | 54                           | -          | -              |

| Dimensions                | I, II & III<br>or IV, V & VI | VII & VIII | VII, VIII & IX |
|---------------------------|------------------------------|------------|----------------|
| Length (m)                | 17.5                         | 25         | 39             |
| Width (m)                 | 11                           | 14         | 14             |
| Height (m)                | 5                            | 5          | 5              |
| Surface (m <sup>2</sup> ) | 180                          | 345        | 537            |



# Floor plan

# ILEC

ILEC CONFERENCE CENTRE  
IBIS LONDON EARLS COURT

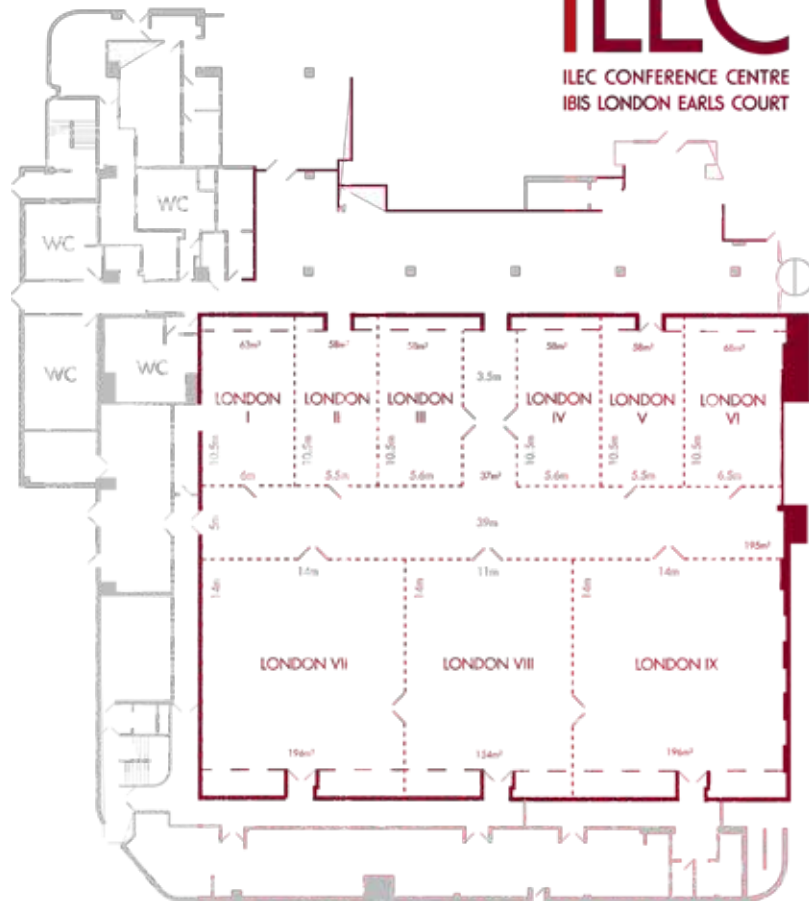

# Sample Configurations



Our five small to medium syndicate rooms have capacity for up to 60 delegates, all with natural daylight, and are ideal as syndicate rooms, hospitality lounges or organiser offices.



You'll never want to meet anywhere else



| <b>Capacity</b>   | Hyde Park        | Regents Park     | Victoria Park    | Greenwich Park I | Greenwich Park II |
|-------------------|------------------|------------------|------------------|------------------|-------------------|
| Theatre           | 50               | 12               | 12               | 12               | 12                |
| Classroom         | 25               | -                | -                | -                | -                 |
| Cabaret           | 40               | -                | -                | -                | -                 |
| Round - Dinner    | 40               | -                | -                | -                | -                 |
| Reception         | 80               | 15               | 15               | 15               | 15                |
| U-shape           | 25               | -                | -                | -                | -                 |
| Boardroom         | 25*              | 12               | 12               | 12               | 12                |
|                   | * 35 if no AV    |                  |                  |                  |                   |
| <b>Dimensions</b> |                  |                  |                  |                  |                   |
| Length            | 13.4m            | 6.0m             | 6.0m             | 6.0m             | 6.0m              |
| Width             | 6.0m             | 3.3m             | 3.3m             | 3.3m             | 3.3m              |
| Height            | 2.1m             | 2.1m             | 2.1m             | 2.1m             | 2.1m              |
| Surface           | 82m <sup>2</sup> | 20m <sup>2</sup> | 20m <sup>2</sup> | 20m <sup>2</sup> | 20m <sup>2</sup>  |





A home away from home

504

International flavours as well as old favourites



Built over 12 floors and with stunning views of the London skyline. Ibis London Earls Court boasts 6 suites and 498 contemporary, spacious and comfortable en-suite bedrooms.

Set in the heart of West London, it benefits from excellent travel links to London's main attractions.

**In-room Services**

Up to 500 TV and satellite channels, pay per movie, affordable WIFI, air-cooling, hairdryer with tea/coffee making facilities...

**Hotel Facilities**

- A buffet and à la carte restaurant
- A traditional English Pub
- 24 hours reception, information desk and snack services
- Underground car park



**La Table Restaurant**

For dining and relaxation, "La table" offers an "À la carte" menu as well as a daily carvery buffet. Seasonal menus are also on offer throughout the year. For your breakfast, both English and Continental options are served daily.

The restaurant has a capacity for up to 160 guests and can easily accommodate small to large groups.

English Heritage



**George & Dragon Pub**

Located on the first floor, the "George & Dragon" is the perfect place to unwind after a busy day, enjoy a sports game or have a light bite while experiencing the atmosphere of a traditional London pub.

A delicious selection from sharing bites to the grill or a range of seasonal salads are served daily and plasma screens, gaming machines and pub games are also available.



# A venue in the heart of West London

Situated a few minutes walk from the international Earls Court Exhibition Centre, ILEC Conference Centre is a perfect base for business travellers. Its close proximity to the shopper's paradise of Kensington and Knightsbridge and the stylish cafes and boutique of Chelsea also makes it a great place for leisure.

The hotel is opposite the Earls Court Exhibition Centre and in close proximity to the Olympia Exhibition Centre and is an ideal stopover whether on business or leisure.

### By road

The venue is located 1/4 mile from the A4, providing easy access to the M4, M5 and M40.

### By Underground

Take the District Line to West Brompton (2 min walk) or the Piccadilly Line to Earls Court (10 min walk).

### By Rail

Midland and Southern trains as well as the London Overground all stop at West Brompton (2 min walk).

### By Air

Heathrow and Gatwick airports are only 30 minutes away by car and city airport is a 45 minute drive to the venue.

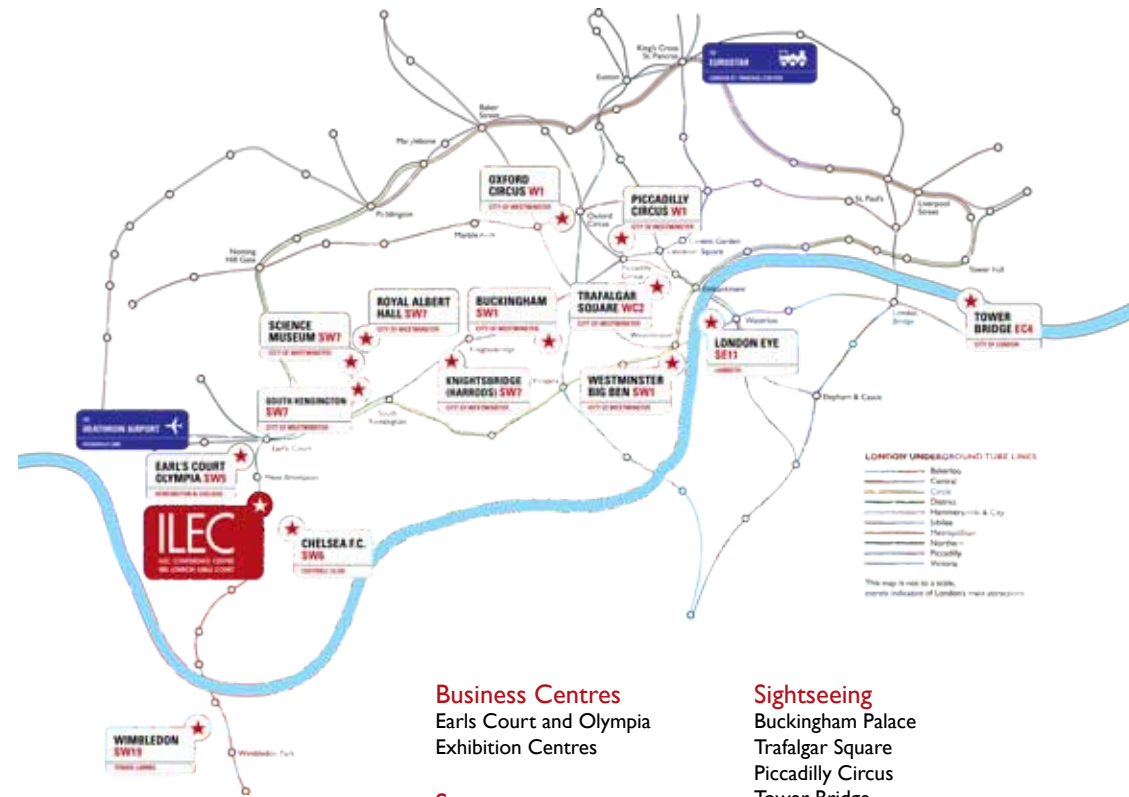

### Business Centres

Earls Court and Olympia Exhibition Centres

### Sports

Chelsea Football Club  
Wimbledon

### Museums

Science Museum  
Royal Albert Hall  
V&A Museum  
Natural History Museum

### Sightseeing

Buckingham Palace  
Trafalgar Square  
Piccadilly Circus  
Tower Bridge  
London Eye  
Big Ben

### Shopping

Oxford Street  
Kensington High Street  
Harrods

